

SF18 Mono Color Silicone LED Linear Flex

SF18-24V-2835-120-2200K-6500K

Specification

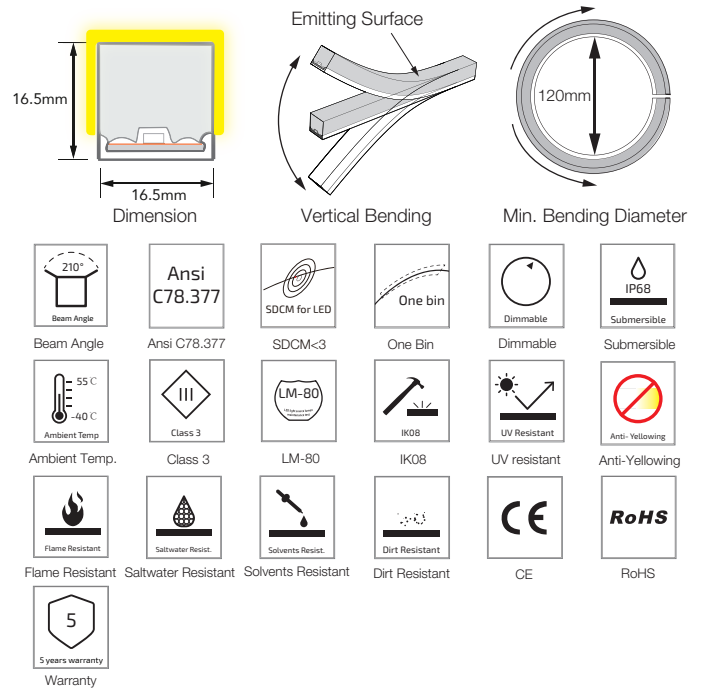
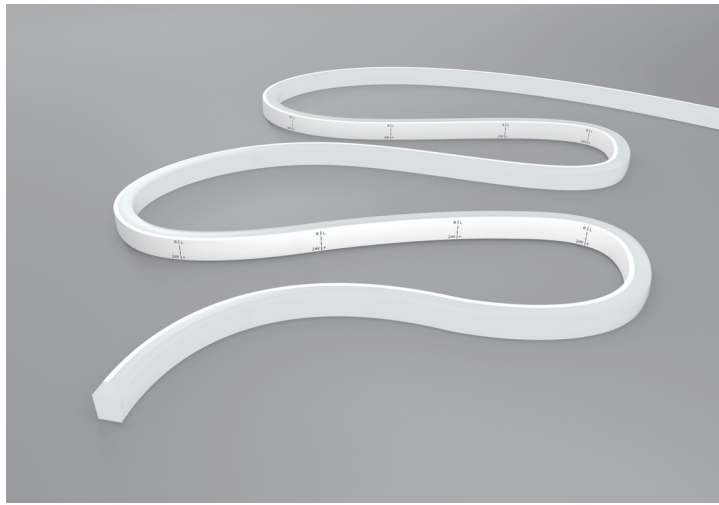

Technical Parameters

Electrical		Optional Color		Lumen Output
Input Voltage	24V DC		2200K(2238±102K)	600lm/m
Power Consumption	10W/m		2700K(2725±145K)	542lm/m
Physical			3000K(3045±175K)	539lm/m
LED Count	120 LEDs/m		3500K(3465±245K)	520lm/m
Cutting Unit	12 LEDs		4000K(3985±275K)	498lm/m
Cutting Unit Length	100 mm		4500K(4503±243K)	490lm/m
Minimum Bend Diameter	120mm		5000K(5029±283K)	480lm/m
Output			6500K(6532±510K)	473lm/m
LED Light	Epistar SMD LED 2835		Green(520-530nm)	430lm/m
CRI	>80, >90		Blue (455-465nm)	86 lm/m
Max Run Length*			Red (620-630nm)	227lm/m
Single Feed	10M		Amber (585-595nm)	140lm/m
Double Feed	20 M			
Beam Angle	210°			
Lumen Maintenance	70,000 Hours L70 @ 25°C 50,000 Hours L70 @ 50°C			
Temperature Ranges				
Installation	0°C to 50°C			
Operating	-40°C to 55°C			
Dependability				
Warranty	5 Years Warranty			
IP Rating	IP68 Wet location submersible <2m			

Illuminance Distribution

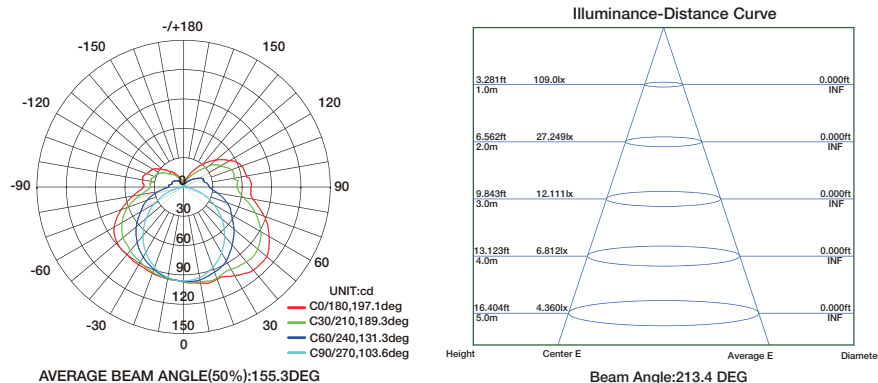

White Color Charts

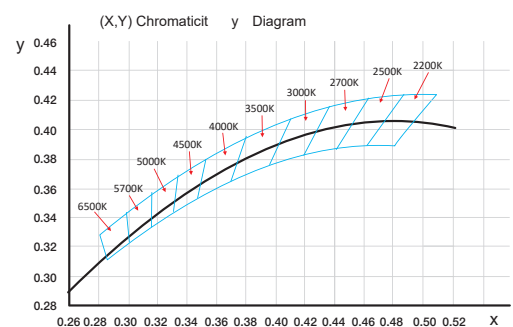

SF18 Mono Color Silicone LED Linear Flex

Connection

